



**DAIKIN ONE WIRELESS RHT
SENSOR QUICK START GUIDE**

Introduction

The Daikin *ONE* Wireless RHT sensor uses Sub-GHz to pair with the Daikin *ONE+* Thermostat. This document provides directions to highlight a quick start.

SPECIFICATIONS

- » Temperature Operating Range -40°F - 130°F
- » Humidity Measurement Range to 5-95%
- » Temperature Sample rate: Once a minute
- » Expected Battery Life - Type CR2450: remote sensor sample rate of 1 per minute: > 1 year
- » Note: Extended extreme temperatures may have a negative impact on range and battery life.

Note:

- » If all remote sensors are removed or have their batteries go dead, then the thermostat will default back to using it's temperature/humidity sensor, whether it was included in the average or not.

Options Available

- » Combined averaging with thermostat and wireless sensors and Averaging with wireless sensors without thermostat.

Assumptions

- » Dealers (not homeowners) will install sensors on walls.
- » Sensors will not be moved around the house.
- » Sensors will not be outside the house.



Quick Install Guide

Dealers

Install the surface mount sensor



Get help at
<https://daikincomfort.com/products/thermostats-controls/rht-sensor>

1. After removing the sensor from the box, remove the pull tab from the sensor to activate the battery.

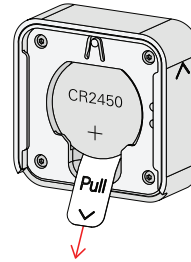

2. Press and hold the blue pair button on the back of the sensor until the LED light flashes red. The sensor will remain in pairing mode for one minute.

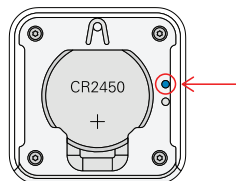

3. Move the sensor to within 3 inches of the thermostat to be paired with. Select "pair sensor" from the pop-up message on the thermostat screen. The LED light will flash green once paired.

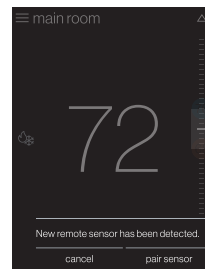

4. Attach a label on the back of each sensor with its sensor name or number to help with later identification. Move the sensor to the desired location without installing it on the wall.

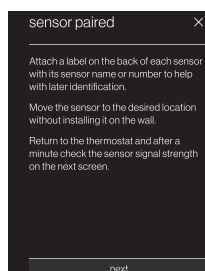

5. After a minute return to the thermostat and check the sensor signal strength on this screen.

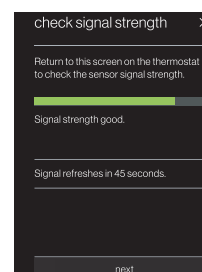

Quick Install Guide

6. If it is not in the green range, move the sensor closer to the thermostat and check the signal strength again after a minute. Repeat until the signal strength is in the green range.

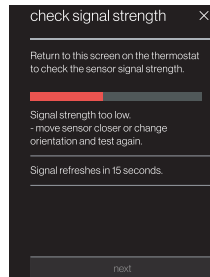

7. Enter sensor calibration settings if desired and select "save."

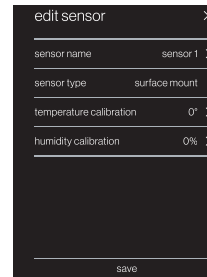

8. Place the wall mount plate on the desired installation location and confirm that it is level.

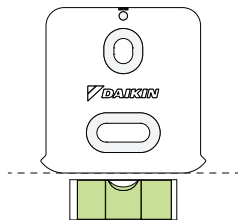

- 9a. Use the two included screws to secure the wall mount onto the selected location. Make sure screws sit flush on the wall mount for a clean installation.

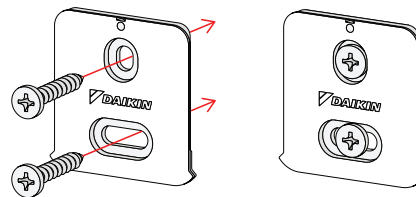

- 9b. Or, use the included adhesive tape to secure the wall mount onto the selected location.

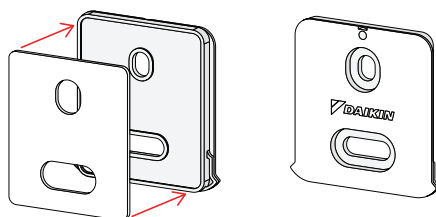

10. Place the sensor onto the wall mount and slide down until it snaps into place. Your sensor is ready for use!

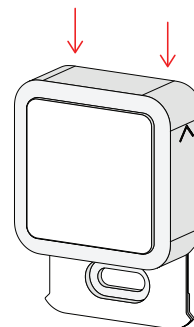

Important Notes

Warranty

Twelve-Year Warranty - This Product is warranted to be free from defects in material and workmanship. If it appears within one year from the date of original installation, whether or not actual use begins on that date, that the product does not meet this warranty, a new or remanufactured part, at the manufacturer's sole option to replace any defective part, will be provided without charge for the part itself provided the defective part is returned to the distributor through a qualified servicing dealer.

THIS WARRANTY DOES NOT INCLUDE LABOR OR OTHER COSTS incurred for diagnosing, repairing, removing, installing, shipping, servicing or handling of either defective parts or replacement parts. Such costs may be covered by a separate warranty provided by the installer.

THIS WARRANTY APPLIES ONLY TO PRODUCTS IN THEIR ORIGINAL INSTALLATION LOCATION AND BECOMES VOID UPON REINSTALLATION.

LIMITATIONS OF WARRANTIES - ALL IMPLIED WARRANTIES (INCLUDING IMPLIED WARRANTIES OF FITNESS FOR A PARTICULAR PURPOSE AND MERCHANTABILITY) ARE HEREBY LIMITED IN DURATION TO THE PERIOD FOR WHICH THE LIMITED WARRANTY IS GIVEN. SOME STATES DO NOT ALLOW LIMITATIONS ON HOW LONG AN IMPLIED WARRANTY LASTS, SO THE ABOVE MAY NOT APPLY TO YOU. THE EXPRESSED WARRANTIES MADE IN THIS WARRANTY ARE EXCLUSIVE AND MAY NOT BE ALTERED, ENLARGED, OR CHANGED BY ANY DISTRIBUTOR, DEALER, OR OTHER PERSON WHATSOEVER.

ALL WORK UNDER THE TERMS OF THIS WARRANTY SHALL BE PERFORMED DURING NORMAL WORKING HOURS. ALL REPLACEMENT PARTS, WHETHER NEW OR REMANUFACTURED, ASSUME AS THEIR WARRANTY PERIOD ONLY THE REMAINING TIME PERIOD OF THIS WARRANTY.

THE MANUFACTURER WILL NOT BE RESPONSIBLE FOR:

1. Normal maintenance as outlined in the installation and servicing instructions or owner's manual, including filter cleaning and/or replacement and lubrication.
2. Damage or repairs required as a consequence of faulty installation, misapplication, abuse, improper servicing, unauthorized alteration or improper operation.
3. Failure to start due to voltage conditions, blown fuses, open circuit breakers or other damages due to the inadequacy or interruption of electrical service.
4. Damage as a result of floods, winds, fires, lightning, accidents, corrosive environments or other conditions beyond the control of the Manufacturer.
5. Parts not supplied or designated by the Manufacturer; or damages resulting from their use.
6. Manufacturer products installed outside the continental U.S.A., Alaska, Hawaii, and Canada.
7. Electricity or fuel costs or increases in electricity or fuel costs for any reason whatsoever including additional or unusual use of supplemental electric heat.
8. ANY SPECIAL INDIRECT OR CONSEQUENTIAL PROPERTY OR COMMERCIAL DAMAGE OF ANY NATURE WHATSOEVER. Some states do not allow the exclusion of incidental or consequential damages, so the above may not apply to you.

This warranty gives you specific legal rights and you may also have other rights which may vary from state to state.

FCC Compliance Statement

This equipment has been tested and found to comply with the limits for a Class B digital device, pursuant to part 15 of the FCC Rules. These limits are designed to provide reasonable protection against harmful interference in a residential installation. This equipment generates, uses and can radiate radio frequency energy and, if not installed and used in accordance with the instructions, may cause harmful interference to radio communications. However, there is no guarantee that interference will not occur in a particular installation. If this equipment does cause harmful interference to radio or television reception, which can be determined by turning the equipment off and on, the user is encouraged to try to correct the interference by one or more of the following measures:

- Reorient or relocate the receiving antenna.
- Increase the separation between the equipment and receiver.
- Connect the equipment into an outlet on a circuit different from that of the receiver.
- Consult the dealer or an experienced radio or TV technician for help.

Notice: Only peripherals complying with FCC limits may be attached to this equipment. Operation with noncompliant peripherals or peripherals not recommended by Venstar, is likely to result in interference to radio and TV reception. Changes or modifications to the product, not expressly approved by Venstar could void the user's authority to operate the equipment.

FCC - INDOOR Mobile Radio Information:

To comply with FCC/IC RF exposure limits for general population / uncontrolled exposure, the antenna(s) used for this transmitter must be installed to provide a separation distance of at least 20 cm from all persons and must not be co-located or operating in conjunction with any other antenna or transmitter.

This Device complies with Industry Canada License-exempt RSS standard(s). Operation is subject to the following two conditions: 1) this device may not cause interference, and 2) this device must accept any interference, including interference that may cause undesired operation of the device.

Under Industry Canada regulations, this radio transmitter may only operate using an antenna of a type and maximum (or lesser) gain approved for the transmitter by Industry Canada. To reduce potential radio interference to other users, the antenna type and its gain should be so chosen that the equivalent isotropically radiated power (e.i.r.p.) is not more than that necessary for successful communication.

Cet appareil est conforme avec Industrie Canada, exempts de licence standard RSS(s). Son fonctionnement est soumis aux deux conditions suivantes: 1) ce dispositif ne doit pas causer d'interférences, et 2) ce dispositif doit accepter toute interférence, y compris les interférences qui peuvent causer un mauvais fonctionnement de l'appareil.

En vertu des règlements d'Industrie Canada, cet émetteur de radio ne peut fonctionner en utilisant une antenne d'un type et maximale (ou moins) Gain approuvé pour l'émetteur par Industrie Canada. Pour réduire les interférences radio potentielles aux autres utilisateurs, le type d'antenne et son gain doivent être choisis afin que la puissance isotrope rayonnée équivalente (PIRE) ne est pas plus de ce qui est nécessaire pour une communication réussie.

We, Venstar, declare under our sole responsibility that the device to which this declaration relates: Complies with Part 15 of the FCC Rules. Operation is subject to the following two conditions: (1) this device may not cause harmful interference, and (2) this device must accept any interference received, including interference that may cause undesired operation.

FCC ID: MUH-SEN10

IC: I2547A-SEN10



**FOR ADDITIONAL
RESOURCES AND
INSTRUCTIONAL VIDEOS,
SCAN CODE OR VISIT:**

WWW.DAIKINCOMFORT.COM



If you encounter any issues or would like assistance,
please contact Daikin support at **1-855-Daikin1**
to be connected with our thermostat support team.

ADDITIONAL INFORMATION

Before purchasing this appliance, read important information about its estimated annual energy consumption, yearly operating cost, or energy efficiency rating that is available from your retailer.



Our continuing commitment to quality products may mean a change in specifications without notice.

© 2025 DAIKIN COMFORT TECHNOLOGIES NORTH AMERICA, INC.

Houston, Texas · USA · www.daikincomfort.com

QSG-ONE-RHT_11-25