

Project Name: _____

Location: _____

Engineer: _____

Submitted to: _____

Submitted by: _____

Reference: _____

Approval: _____

Date: _____

Construction: _____

Unit #: _____

Drawing #: _____

For use with the following VRV indoor unit models: FXAQ, FXDQ, FXFQ, FXHQ, FXLQ, FXMQ, FXMQ_MF, FXNQ, FXSQ, FXTQ, FXZQ

For use with the following Daikin SkyAir indoor unit models: FAQ, FBQ, FCQ, FHQ, FTQ

Model	BRC1E72
Description	New Navigation Remote Controller
Maximum Indoor Units	16
Communication Wire	18AWG-2, No polarity Stranded, Non-shielded
Total Wiring Length	1,640 ft (500 m)
Communication Protocol	Daikin Proprietary P1P2 protocol
Power	16VDC supplied by Indoor unit (1.58VA maximum)
Comfort Setpoint Range	60 to 90 °F (16 to 32 °C)
Setback Setpoint Range	40 to 95 °F (5 to 35 °C)
Operating Temp Range	14 to 122 °F (-10 to 50 °C)
Operating Humidity Range	75% or less (w/o condensation)
Dimensions (WxHxD)	4.72x4.72x0.75 inch (120x120x19 mm)
Weight (Mass)	0.42 lb (0.19 kg)

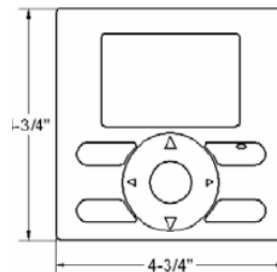

Features / Benefits:

- Up to 16 indoor units are controllable in one group
- Can be combined with a secondary controller for dual operation
- Backlit LCD display in English, French, or Spanish
- Temperature sensor with configurable offset
- Display of Temperature and Setpoint in 1°F / °C increments
- Three display modes Detailed, Standard and Simple
- Dual setpoints (individual cooling and heating setpoints) with minimum setpoint differential or Single setpoint (occupied period)
- Setpoint range limits for Cooling and Heating
- Independent cool/heat setback setpoints (unoccupied period)
- Auto changeover mode can automatically change to cool/heat mode at setpoint +/-1° F (can be configured from 1 to 4° F using field settings) with a guard timer for 15, 30, 60 or 90 min. Surely change at another +/-1° F (can be configured from 1 to 4° F using field settings) ignoring the guard timer.
- Built in 7, 5+2, 5+1+1, and 1 (Everyday) schedule with up to 5 actions per day with independent cool/heat or setback setpoints
- Automatic adjustment for Daylight Savings Time (DST)
- 48 hour clock/calendar backup (in case of power failure)
- Constantly monitors the system for malfunctions with immediate display of fault location and condition
- Prohibit buttons on remote controller
- Limit selectable operation modes
- Display can be configured not to show setpoint when unit is Off. Display Off, instead of mode when unit is off. Fan speed display removable.
- Backwards compatible

Daikin AC (Americas), Inc., 1645 Wallace Drive, Suite 110, Carrollton, TX 75006

Daikin AC Controls Engineering Department Generated Submittal Data

www.daikinac.com







Project Name: _____
 Location: _____
 Engineer: _____
 Submitted to: _____
 Submitted by: _____
 Reference: _____

Approval: _____
 Date: _____
 Construction: _____
 Unit #: _____
 Drawing #: _____

Face Decal Options:

- Face decal options to hide unnecessary buttons
 - Hidden buttons can be used/accessed by service personnel without removing the face decal due to its flexibility



Used with	Single Setpoint mode			Dual Setpoint mode		
	BRC1E72RM	BRC1E72RF	BRC1E72RMF	BRC1E72RM2	BRC1E72RF2	BRC1E72RMF2
Model						
On/Off	X	X	X	X	X	X
Mode	X		X	X		X
Fan		X	X		X	X
Up, Down	X	X	X	X	X	X
Left, Right				X	X	X
Menu/OK						
Cancel						