

intelligent Touch Manager (iTM)

One for all

The intelligent Touch Manager (iTM) is an advanced multi-zone controller that provides the most cost-effective way to control and monitor the Daikin VRV system.

Centralized and Advanced VRV Control

Up to 64 Indoor Unit Groups (128 actual Indoor Units) can be monitored and controlled with individual Cool and Heat Setpoints, Setpoint Range Limitation, Setback Setpoints, and Auto changeover to meet your expectations and project requirements. Up to 512 Indoor Unit Groups (1024 actual Indoor Units) can be monitored and controlled with the addition of up to 7 optional iTM Plus Adapters.

Ancillary Equipment Control

Integrates and/or interlocks sensors, switches, dampers, fans, pumps, and lighting with Daikin Indoor Units.

Web Access and Alert E-mail

Allows daily remote monitoring and control with the Web/E-mail function that can be accessed via the facility's Local Area Network or your Internet connection. Sends Error E-mail to mobile devices with the Web/E-mail function.

Tenant Billing

Determines energy consumption of shared condensing units based upon tenant (Indoor Unit) demand with optional PPD Software option (DCM002A71).



Features

- 10.4" LCD touch screen, USB drive
- Advanced, scalable and cost-effective management system
 - Up to 650 points (max 512 indoor unit groups (1024 indoor units))
 - Floor plan layout view
- 24v DC Power Supply

Functions

- Dual setpoints or Single setpoint in Occ or Setback in Unocc
- Setpoint Range Limitation
- Scheduling (7 day, Weekday-Weekend, Weekday-Saturday-Sunday, Everyday)
- Optimum Start and Timed Override
- Advanced Auto changeover
 - Applicable to both VRV Heat Pump and Heat Recovery systems
 - Fixed, Individual, Average and Vote methods
- Web Accessibility and Alert Email (standardized)
 - All screen views and configuration menus can be accessed through Web
- WAGO I/O
 - Monitor and control 3rd party equipment with Di, Do and Ai signals
 - Up to 512 management points
 - Interlock function with indoor units and ancillary equipment

Advanced multi-zone controllers

| ITEM | | | | MODEL NO. | FUNCTION |
|---------------------------|----------|----------|---------------------------|-----------|---|
| intelligent Touch Manager | Basic | Hardware | intelligent Touch Manager | DCM601A71 | Air-conditioning management system that can be controlled by touch screen or web browser to monitor and control up to 64 groups (10 outdoor units). |
| | Optional | Hardware | iTM Plus Adapter | DCM601A72 | Maximum 7 iTM Plus Adapters can be connected to intelligent Touch Manager. Each iTM Plus Adapter can add and additional 64 groups (10 outdoor units) |
| | | Software | iTM PPD Option | DCM002A71 | Power consumption of indoor units are calculated based on operation status of the indoor unit and outdoor unit power consumption measured by kWh meter. |

WAGO

| ITEM | MODEL NO. | FUNCTION |
|---|-----------------|---|
| Basic Kit (required for each Node) | 51291052 | Bus Coupler MODBUS (RS485) Communication, 24VDC input End Module To loop the internal bus Connector D-Sub male connector: 9 pin, 2 horizontal wire entries, one input and one output 24 VDC Power Supply Input voltage 110 – 240VAC, output voltage 24VDC @ 2.5A |
| 2 Channel Digital Input | 750-400 | 2 Channel, DC 24V, 3.0ms, high-side switching |
| 4 Channel Digital Input | 750-432 | 4 Channel, DC 24V, 3.0ms, low-side switching, w/(+) terminal |
| 2 Channel Digital Output | 750-513/000-001 | 2 Channel, AC 230V, DC 30V, AC/DC 2A, isolated outputs |
| 2 Channel Analog Input | 750-454 | 2 Channel, 4 - 20 mA, Differential Inputs |
| | 750-479 | 2 Channel, DC ± 10 V, Differential measurement input |
| | 750-461/020-000 | 2 Channel, NTC 20K Ohm Resistance |
| 24 VDC Power Supply (Passive) (required for every 32 contact points used) | 750-602 | 24 VDC Passive |
| Wiring | Field Supplied | 2 conductor 24 – 18 AWG stranded |

iTM system overview

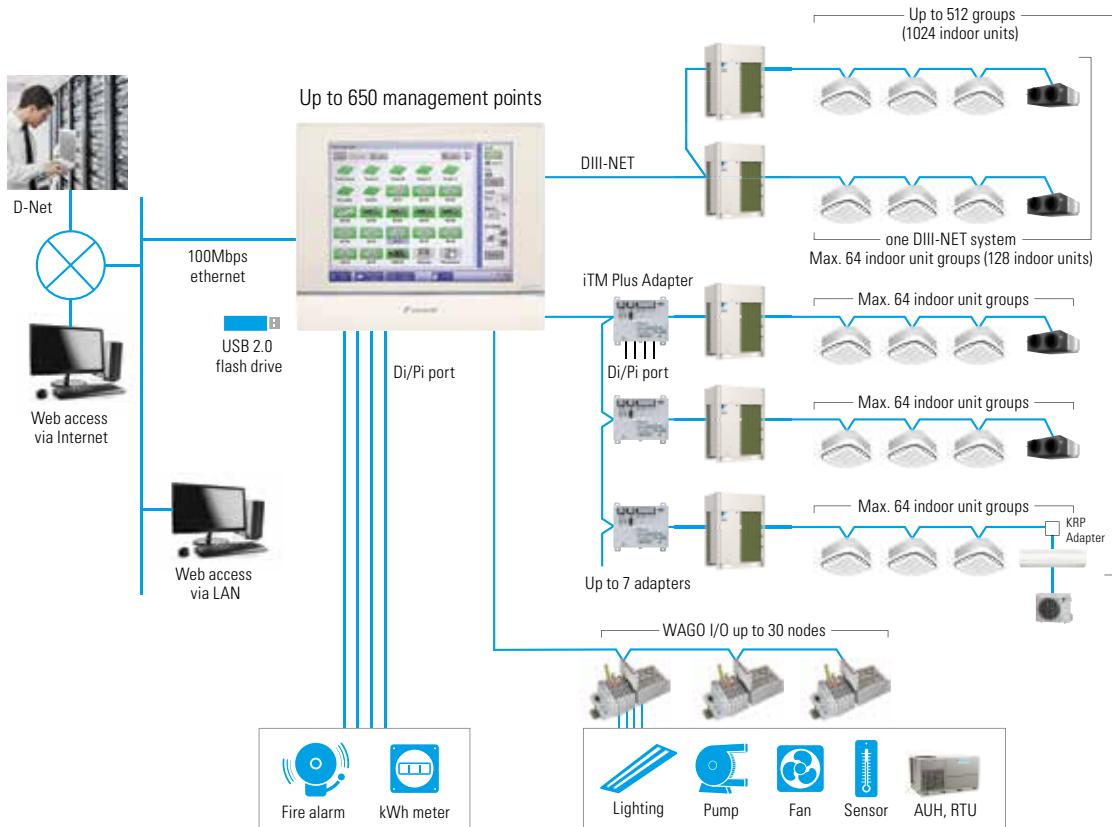

Our continuing commitment to quality products may mean a change in specifications without notice.
 © 2015 **DAIKIN NORTH AMERICA LLC** · Houston, Texas · USA · www.daikincomfort.com